**IR60X68X35-XL** [↗](#)

Inner ring

Inner ring IR..-XL, cylindrical

X-life

Teknik bilgiler

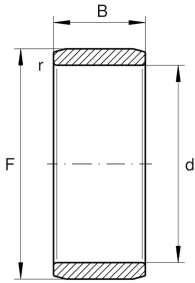

Ваш текущий вариант продукта

Lubrication hole Without

Special features Without

Main Dimensions & Performance Data

d	60 mm	Bore diameter
F	68 mm	Raceway diameter inner ring
B	35 mm	Width
	-0,01 mm	Raceway diameter upper tolerance
	-0,021 mm	Raceway diameter lower tolerance
r _{min}	0,6 mm	Minimum chamfer dimension
≈m	0,214 kg	Ağırlık