**NKX12-Z-XL**

Needle roller/axial ball bearing

Needle roller/axial ball bearings NKX...-Z, axial component, single direction, to DIN 5429, with end cap, for grease lubrication

X-life

Teknik bilgiler

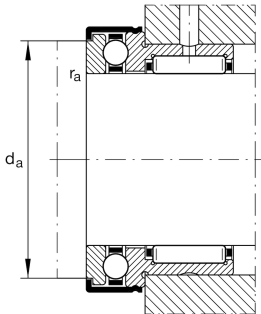
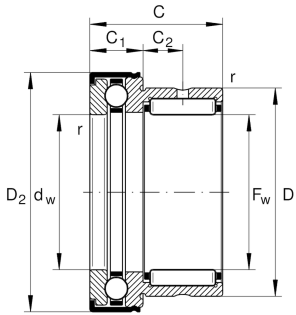

Mevcut ürün modeliniz

Type of Seal	Z	Bearing with end cap
Cage	Standard	

Main Dimensions & Performance Data

F_w	12 mm	Bore diameter
D	21 mm	Outside diameter
C	23 mm	Height
C_r	10.100 N	Basic dynamic load rating, radial
C_{0r}	11.000 N	Basic static load rating, radial
C_a	10.300 N	Basic dynamic load rating, axial
C_{0a}	15.400 N	Basic static load rating, axial
C_{ur}	1.950 N	Fatigue load limit, radial
C_{ua}	760 N	Fatigue load limit, axial
n_G	11.000 1/min	Limiting speed
$\approx m$	42,73 g	Ağırlık

Mounting dimensions

d_a	21,7 mm	Mounting dimension shaft shoulder
$r_{a \max}$	0,3 mm	Maximum recess radius



Dimensions

D 1 max	27,2 mm	Maximum outside diameter flange
D 2 max	27,2 mm	Maximum outside diameter flange
C 1	9 mm	Width of the axial bearing component
C 1	6,5 mm	Distance to lubrication hole
C 2	6,5 mm	Distance to lubrication hole
d w	12 mm	Bore diameter of shaft washer
r min	0,3 mm	Minimum chamfer dimension

Temperature range



T min	-30 °C	Operating temperature min.
T max	120 °C	Operating temperature max.

Additional information

IR9X12X16-XL

Suitable inner rings IR

Özellikleri

-  Radyal yük
-  Tek yönde aksel yük
-  Gres yağlama
-  Tek taraflı conta