



81210-TV [↗](#)

Axial cylindrical roller bearing

Axial-Zylinderrollenlager 874, einseitig wirkend, kombiniert aus K874, GS, WS

Technische Informationen

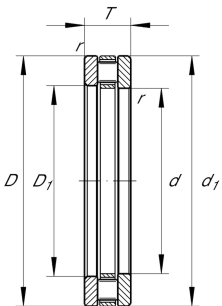

Mevcut ürün modeliniz

Käfig	TV	Kunststoffkäfig aus PA66
-------	----	--------------------------

Main Dimensions & Performance Data

d	50 mm	Bore diameter
T	22 mm	Height
C _a	118.000 N	Basic dynamic load rating, axial
C _{0a}	315.000 N	Basic static load rating, axial
C _{ua}	28.000 N	Fatigue load limit, axial
n _G	4.500 1/min	Limiting speed
n _{gr}	1.550 1/min	Reference speed
D	78 mm	Outside diameter
≈m	361,5 g	Ağırlık

Mounting dimensions

d _{a min}	75 mm	Minimum diameter shaft shoulder
D _{a max}	53 mm	Maximum diameter of housing shoulder
r _{a max}	1 mm	Maximum recess radius

Dimensions

D ₁	52 mm	Bore diameter housing washer
d ₁	78 mm	Rip diameter shaft washer
r _{min}	1 mm	Minimum chamfer dimension







Temperature range

T _{min}	-30 °C	Operating temperature min.
T _{max}	120 °C	Operating temperature max.

Additional information

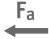
K81210-TV	Axial roller and cage assembly
GS81210	Housing Washer
WS81210	Shaft washer
LS7095	Track Washer

Özellikleri

-  Tek yönde eksenel yük
-  Gres yağlama
-  Yağ ile yağlama
-  Contasız