



**FAG**

**S2SAFH-110MM-FL**

Узел стационарного корпуса

FAG split cylindrical roller bearing housing



Техническая информация

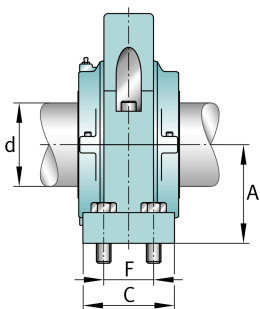
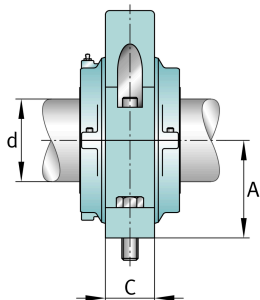
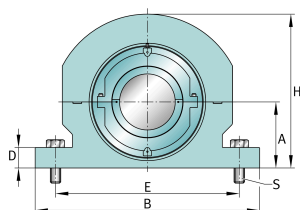

**Основные размеры и рабочие характеристики**

d	110 mm	Shaft diameter
H	346,075 mm	Housing height
A	152,4 mm	Center height
B	466,725 mm	Length Base
≈m	81,647 kg	Вес

**Габаритные размеры**

	S2SAFH-110MM-HD	Complete unit held
	S2SAFH-110MM-FL	Complete unit float
	SAFC-526	Housing designation
D	60,325 mm	Base height
C	130,175 mm	Base width
E <sub>max</sub>	406,4 mm	Base hole distance 1 max
E <sub>min</sub>	371,475 mm	Base hole distance 1
F	82,55 mm	Base hole distance 2
S	4	# of Mounting Bolts
S	22,225 mm	Mounting bolt diameter