



**FAG**

**S2SAFH-140MM-HD**

Узел стационарного корпуса

FAG split cylindrical roller bearing housing

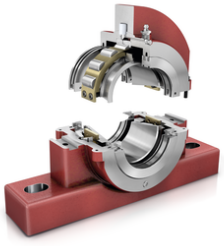

Техническая информация

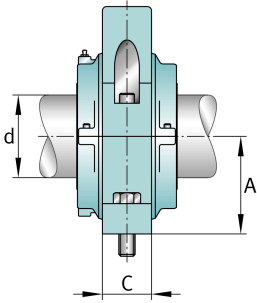
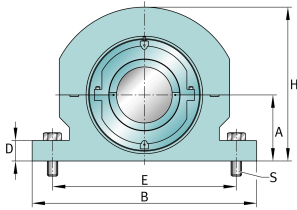

**Основные размеры и рабочие характеристики**

d	140 mm	Shaft diameter
H	423,862 mm	Housing height
A	169,862 mm	Center height
B	558,8 mm	Length Base
≈m	131,542 kg	Вес

**Габаритные размеры**

	S2SAFH-140MM-HD	Complete unit held
	S2SAFH-140MM-FL	Complete unit float
	SAFC-532	Housing designation
D	68,263 mm	Base height
C	158,75 mm	Base width
E <sub>max</sub>	488,95 mm	Base hole distance 1 max
E <sub>min</sub>	441,325 mm	Base hole distance 1
F	95,25 mm	Base hole distance 2
S	4	# of Mounting Bolts
S	25,4 mm	Mounting bolt diameter