



FAG

S2SAFH-115MM-HD [↗](#)

Узел стационарного корпуса

FAG split cylindrical roller bearing housing

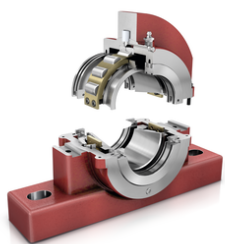

Техническая информация

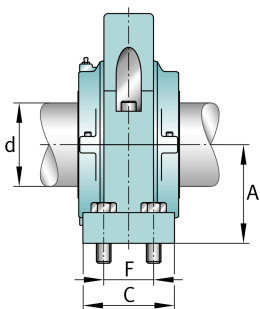
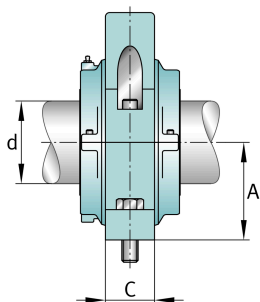
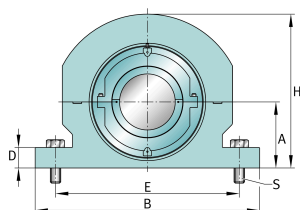

Основные размеры и рабочие характеристики

d	115 mm	Shaft diameter
H	346,075 mm	Housing height
A	152,4 mm	Center height
B	466,725 mm	Length Base
≈m	81,647 kg	Вес

Габаритные размеры

	S2SAFH-115MM-HD	Complete unit held
	S2SAFH-115MM-FL	Complete unit float
	SAFC-526	Housing designation
D	60,325 mm	Base height
C	130,175 mm	Base width
E _{max}	406,4 mm	Base hole distance 1 max
E _{min}	371,475 mm	Base hole distance 1
F	82,55 mm	Base hole distance 2
S	4	# of Mounting Bolts
S	22,225 mm	Mounting bolt diameter