



FAG

S2SAFH-75MM-HD [↗](#)

Узел стационарного корпуса

FAG split cylindrical roller bearing housing



Техническая информация

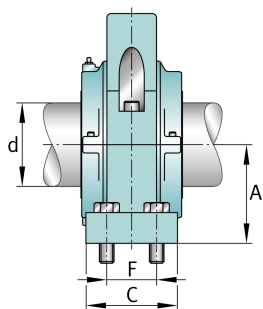
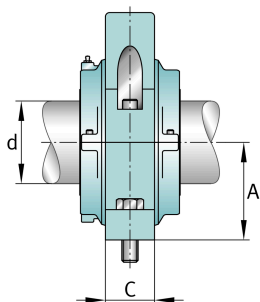
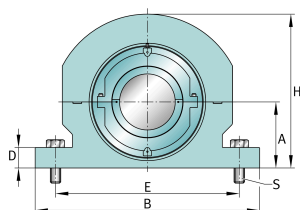

Основные размеры и рабочие характеристики

d	75 mm	Shaft diameter
H	238,125 mm	Housing height
A	95,25 mm	Center height
B	330,2 mm	Length Base
≈m	25,401 kg	Bec

Габаритные размеры

	S2SAFH-75MM-HD	Complete unit held
	S2SAFH-75MM-FL	Complete unit float
	SAFC-517	Housing deignation
D	26,987 mm	Base height
C	88,9 mm	Base width
E _{max}	279,4 mm	Base hole distance 1 max
E _{min}	250,825 mm	Base hole distance 1
F	53,975 mm	Base hole distance 2
S	4	# of Mounting Bolts
S	15,875 mm	Mounting bolt diameter