



FAG

S1SNLH-170MM-FL [↗](#)

Узел стационарного корпуса

FAG split cylindrical roller bearing housing



Техническая информация

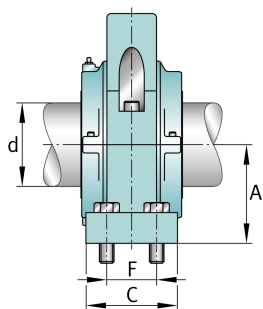
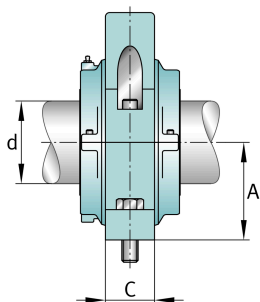
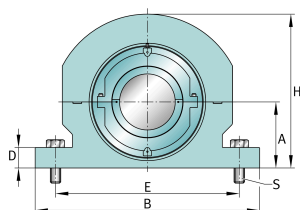

Основные размеры и рабочие характеристики

d	170 mm	Shaft diameter
H	425,45 mm	Housing height
A	190,5 mm	Center height
B	639,762 mm	Length Base
≈m	128,367 kg	Bec

Габаритные размеры

	S1SNLH-170MM-HD	Complete unit held
	S1SNLH-170MM-FL	Complete unit float
	SNLH-12	Housing designation
D	55,563 mm	Base height
C	120,65 mm	Base width
E	590,55 mm	Base hole distance 1
F	25,4 mm	Base hole distance 2
S	4	# of Mounting Bolts
S	25,4 mm	Mounting bolt diameter