



FAG

S1SNLH-150MM-FL [↗](#)

Узел стационарного корпуса

FAG split cylindrical roller bearing housing

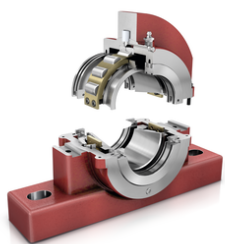

Техническая информация

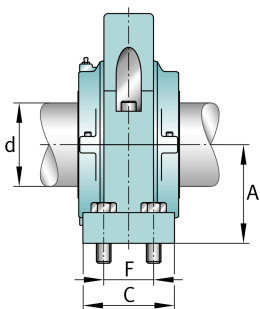
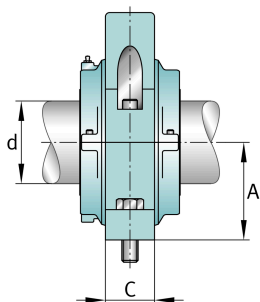
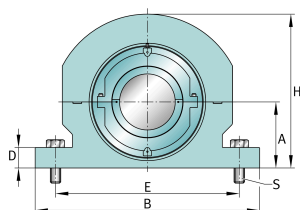

Основные размеры и рабочие характеристики

| | | |
|----|------------|----------------|
| d | 150 mm | Shaft diameter |
| H | 388,938 mm | Housing height |
| A | 169,862 mm | Center height |
| B | 549,275 mm | Length Base |
| ≈m | 102,058 kg | Bec |

Габаритные размеры

| | | |
|---|-----------------|------------------------|
| | S1SNLH-150MM-HD | Complete unit held |
| | S1SNLH-150MM-FL | Complete unit float |
| | SNLH-10 | Housing designation |
| D | 50,8 mm | Base height |
| C | 95,25 mm | Base width |
| E | 479,425 mm | Base hole distance 1 |
| S | 2 | # of Mounting Bolts |
| S | 31,75 mm | Mounting bolt diameter |