



FAG

S1SNLH-408-FL-2B [↗](#)

Узел стационарного корпуса

FAG split cylindrical roller bearing housing



Техническая информация

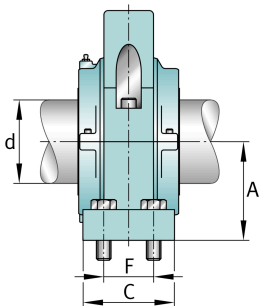
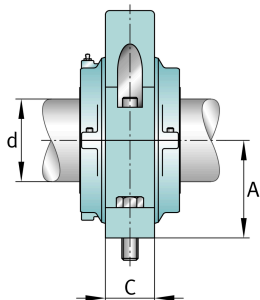
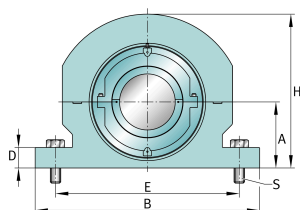

Основные размеры и рабочие характеристики

d	114,3 mm	Shaft diameter
H	311,15 mm	Housing height
A	139,7 mm	Center height
B	409,575 mm	Length Base
≈m	49,895 kg	Bec

Габаритные размеры

	S1SNLH-408-HD-2B	Complete unit held
	S1SNLH-408-FL-2B	Complete unit float
	SNLH-7-2B	Housing designation
D	39,688 mm	Base height
C	73,025 mm	Base width
E	352,425 mm	Base hole distance 1
S	2	# of Mounting Bolts
S	25,4 mm	Mounting bolt diameter