



FAG

S1SNLH-600-HD

Узел стационарного корпуса

FAG split cylindrical roller bearing housing



Техническая информация

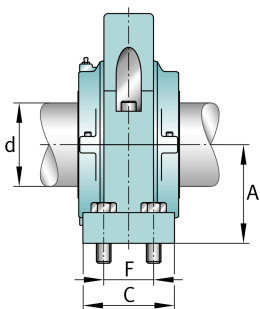
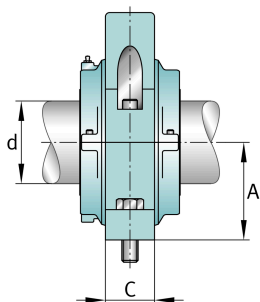
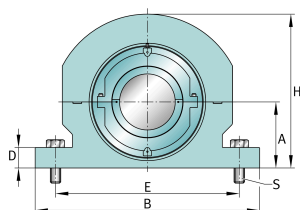

Основные размеры и рабочие характеристики

d	152,4 mm	Shaft diameter
H	388,938 mm	Housing height
A	169,862 mm	Center height
B	549,275 mm	Length Base
≈m	102,058 kg	Bec

Габаритные размеры

S1SNLH-600-HD	Complete unit held	
S1SNLH-600-FL	Complete unit float	
SNLH-10	Housing designation	
D	50,8 mm	Base height
C	95,25 mm	Base width
E	479,425 mm	Base hole distance 1
S	2	# of Mounting Bolts
S	31,75 mm	Mounting bolt diameter