



FAG

S1SNLH-115MM-HD [↗](#)

Узел стационарного корпуса

FAG split cylindrical roller bearing housing



Техническая информация

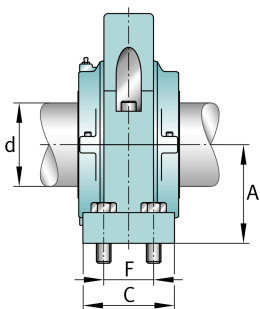
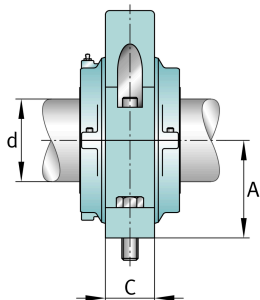
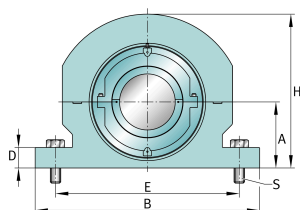

Основные размеры и рабочие характеристики

d	115 mm	Shaft diameter
H	295,275 mm	Housing height
A	123,825 mm	Center height
B	377,825 mm	Length Base
≈m	49,895 kg	Bec

Габаритные размеры

	S1SNLH-115MM-HD	Complete unit held
	S1SNLH-115MM-FL	Complete unit float
	SNLH-7	Housing designation
D	34,925 mm	Base height
C	142,875 mm	Base width
E	323,85 mm	Base hole distance 1
F	88,9 mm	Base hole distance 2
S	4	# of Mounting Bolts
S	25,4 mm	Mounting bolt diameter