

FAG

S1BCH-315-FL [↗](#)

Узел стационарного корпуса

FAG split cylindrical roller bearing housing

Техническая информация

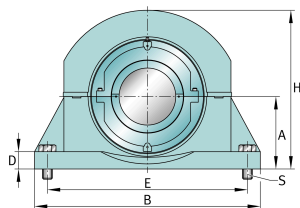

Основные размеры и рабочие характеристики

d	3,938 in	Shaft diameter
B	16,75 in	Length base
H	10,75 in	Housing height
≈m	83,599 lbs	Bec



Габаритные размеры

	S1BCH-315-FL	Complete unit float
	S1BCH-315-HD	Complete unit held
	PH-6	Housing designation
A	4,938 in	Center height
C	6 in	Base width
D	2 in	Base height
E _{min}	14 in	Base hole distance 1 min
E _{max}	15 in	Base hole distance 1 max
F	4 in	Base hole distance 2
S	4	# of mounting bolts
S	0,75 in	Mounting bolt diameter
	S1BC-315-FL	Cartridge float bearing
	S1BC-315-HD	Cartridge held bearing
	S1C-400	Cartridge
G	5,188 in	Length through bore
L	8 in	Outside diameter cartridge
	781 lbs	Grease capacity
	32,3 lbs	Cartridge weight
	S1B-315-FL	Bearing float
	S1B-315-HD	Bearing held
	13,9 lbs	Bearing weight
	400 Grp	Housing group
C _r	50.872 lbf	Динамическая грузоподъемность, радиальная
C _{0r}	72.572 lbf	Статическая грузоподъемность, радиальная
C _a	548 lbf	Динамическая грузоподъемность, осевая
	2,400 1/min	Limiting speed
D ₀	6,875 in	Outside diameter bearing
C ₀	3,188 in	Width inner ring
B ₀	1,781 in	Width outer ring





Просмотреть сведения о продукте на medias

26.05.2026, 06:56:41 UTC

SCHAEFFLER

