



FAG

S3BCH-900-HD [↗](#)

Узел стационарного корпуса

FAG split cylindrical roller bearing housing

Техническая информация

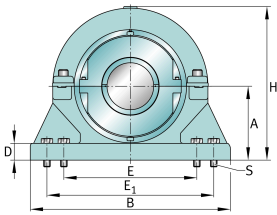

Основные размеры и рабочие характеристики

d	9 in	Shaft diameter
H	28,75 in	Housing height
B	37,5 in	Length base
≈m	1.658,996 lbs	Bec



Габаритные размеры

	S3BCH-900-FL	Complete unit float
	S3BCH-900-HD	Complete unit held
	PH-314	Housing designation
A	13,75 in	Center height
C	11 in	Base width
D	3 in	Base height
E _{min}	28,25 in	Base hole distance 1 min
E _{max}	29,75 in	Base hole distance 1 max
F	7 in	Base hole distance 2
s	4	# of mounting bolts
s	1,75 in	Mounting bolt diameter
	S3BC-900-FL	Cartridge float bearing
	S3BC-900-HD	Cartridge held bearing
	S3C-900	Cartridge
G	13,188 in	Lenght through bore
L	21,5 in	Outside diameter cartridge
	15 lbs	Grease capacity
	719 lbs	Cartridge weight
	S3B-900-FL	Bearing float
	S3B-900-HD	Bearing held
	342 lbs	Bearing weight
	900 Grp	Bearing Group
C _r	367.400 lbf	Динамическая грузоподъемность, радиальная
C _{0r}	586.233 lbf	Статическая грузоподъемность, радиальная
C _a	18.652 lbf	Динамическая грузоподъемность, осевая
	972 1/min	Limiting speed
D ₀	18,5 in	Outside diameter bearing
C ₀	8,346 in	Width inner ring
B ₀	5,185 in	Width outer ring





Просмотреть сведения о продукте на medias

10.07.2026, 15:02:20 UTC

SCHAEFFLER

