



**FAG**

## S1BCH-1000-HD [↗](#)

Узел стационарного корпуса

FAG split cylindrical roller bearing housing

### Техническая информация

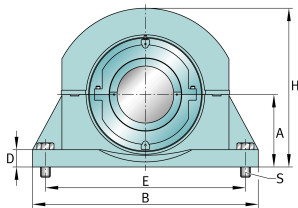

#### Основные размеры и рабочие характеристики

d	10 in	Shaft diameter
B	27 in	Length base
H	23 in	Housing height
≈m	511,999 lbs	Bec



**Габаритные размеры**

	S1BCH-1000-FL	Complete unit float
	S1BCH-1000-HD	Complete unit held
	PH-15	Housing designation
A	11,5 in	Center height
C	9 in	Base width
D	1,75 in	Base height
E <sub>min</sub>	19 in	Base hole distance 1 min
E <sub>max</sub>	20,5 in	Base hole distance 1 max
F	5,5 in	Base hole distance 2
S	4	# of mounting bolts
S	1,25 in	Mounting bolt diameter
	S1BC-1000-FL	Cartridge float bearing
	S1BC-1000-HD	Cartridge held bearing
	S1C-1000	Cartridge
G	8,75 in	Length through bore
L	16,5 in	Outside diameter cartridge
	4,2 lbs	Grease capacity
	226,9 lbs	Cartridge weight
	S1B-1000-FL	Bearing float
	S1B-1000-HD	Bearing held
	82 lbs	Bearing weight
	1000 Grp	Housing group
C <sub>r</sub>	135.143 lbf	Динамическая грузоподъемность, радиальная
C <sub>0r</sub>	264.517 lbf	Статическая грузоподъемность, радиальная
C <sub>a</sub>	9.218 lbf	Динамическая грузоподъемность, осевая
	1.080 1/min	Limiting speed
D <sub>0</sub>	14,75 in	Outside diameter bearing
C <sub>0</sub>	4,803 in	Width inner ring
B <sub>0</sub>	2,625 in	Width outer ring





Просмотреть сведения о продукте на medias

26.05.2026, 06:40:05 UTC

SCHAEFFLER

