

FAG

S1BCH-808-HD [↗](#)

Узел стационарного корпуса

FAG split cylindrical roller bearing housing

Техническая информация

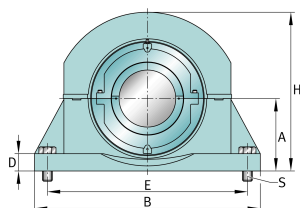

Основные размеры и рабочие характеристики

d	8,5 in	Shaft diameter
B	25 in	Length base
H	21,25 in	Housing height
≈m	371,999 lbs	Bec



Габаритные размеры

	S1BCH-808-FL	Complete unit float
	S1BCH-808-HD	Complete unit held
	PH-14	Housing designation
A	10,625 in	Center height
C	8,5 in	Base width
D	1,625 in	Base height
E _{min}	17,375 in	Base hole distance 1 min
E _{max}	18,875 in	Base hole distance 1 max
F	5,5 in	Base hole distance 2
S	4	# of mounting bolts
S	1,25 in	Mounting bolt diameter
	S1BC-808-FL	Cartridge float bearing
	S1BC-808-HD	Cartridge held bearing
	S1C-900	Cartridge
G	8,5 in	Length through bore
L	15,25 in	Outside diameter cartridge
	3,3 lbs	Grease capacity
	174 lbs	Cartridge weight
	S1B-808-FL	Bearing float
	S1B-808-HD	Bearing held
	63 lbs	Bearing weight
	900 Grp	Housing group
C _r	121.053 lbf	Динамическая грузоподъемность, радиальная
C _{0r}	221.583 lbf	Статическая грузоподъемность, радиальная
C _a	8.509 lbf	Динамическая грузоподъемность, осевая
	1.190 1/min	Limiting speed
D ₀	13,5 in	Outside diameter bearing
C ₀	4,528 in	Width inner ring
B ₀	2,5 in	Width outer ring

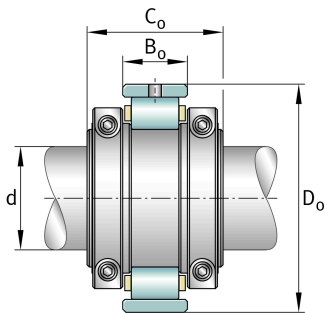
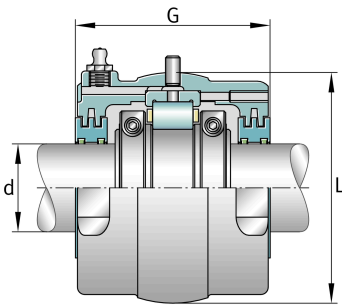
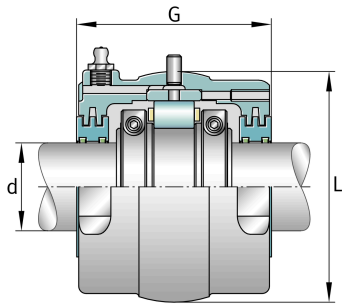
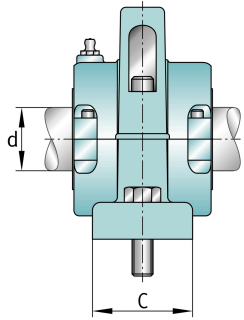
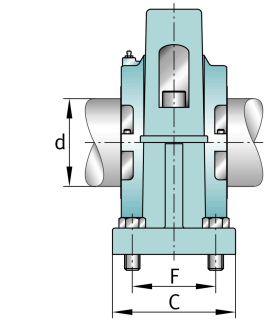



Просмотреть сведения о продукте на medias

21.05.2026, 01:58:18 UTC

SCHAEFFLER

