



FAG

S1BCH-100MM-HD-2B [↗](#)

Узел стационарного корпуса

FAG split cylindrical roller bearing housing

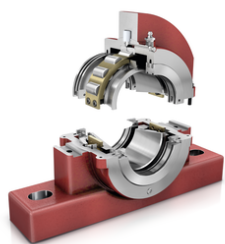

Техническая информация

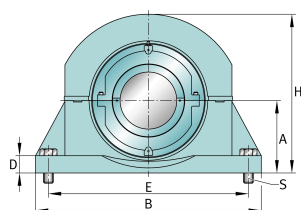

Основные размеры и рабочие характеристики

| | | |
|----|-----------|----------------|
| d | 100 mm | Shaft diameter |
| B | 425,45 mm | Length base |
| H | 273,05 mm | Housing height |
| ≈m | 34,11 kg | Вес |



Габаритные размеры

| | | |
|------------------|-------------------|---|
| | S1BCH-100MM-FL-2B | Complete unit float |
| | S1BCH-100MM-HD-2B | Complete unit held |
| | PH-6-2B | Housing designation |
| A | 125,412 mm | Center height |
| C | 107,95 mm | Base width |
| D | 50,8 mm | Base height |
| E _{min} | 342,9 mm | Base hole distance 1 min |
| E _{max} | 377,825 mm | Base hole distance 1 max |
| S | 2 | # of mounting bolts |
| S | 19,05 mm | Mounting bolt diameter |
| | S1BC-100MM-FL | Cartridge float bearing |
| | S1BC-100MM-HD | Cartridge held bearing |
| | S1C-400 | Cartridge |
| G | 131,762 mm | Length through bore |
| L | 203,2 mm | Outside diameter cartridge |
| | 354,256 kg | Grease capacity |
| | 14,651 kg | Cartridge weight |
| | S1B-100MM-FL | Bearing float |
| | S1B-100MM-HD | Bearing held |
| | 6,305 kg | Bearing weight |
| | 400 Grp | Housing group |
| C _r | 226.278,656 N | Динамическая грузоподъемность, радиальная |
| C _{0r} | 322.800,256 N | Статическая грузоподъемность, радиальная |
| C _a | 2.437,504 N | Динамическая грузоподъемность, осевая |
| | 2.400 1/min | Limiting speed |
| D ₀ | 174,625 mm | Outside diameter bearing |
| C ₀ | 80,975 mm | Width inner ring |
| B ₀ | 45,237 mm | Width outer ring |

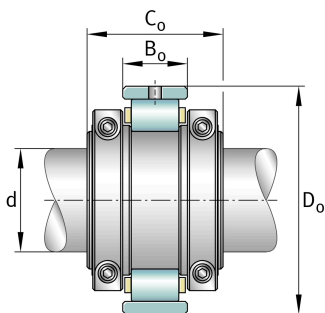



Просмотреть сведения о продукте на medias

26.05.2026, 18:27:32 UTC

SCHAEFFLER

