



**FAG**

## S1BCH-107-HD [↗](#)

Узел стационарного корпуса

FAG split cylindrical roller bearing housing

### Техническая информация

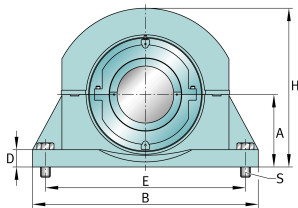

#### Основные размеры и рабочие характеристики

d	1,438 in	Shaft diameter
B	9 in	Length base
H	5,5 in	Housing height
≈m	11,05 lbs	Bec



### Габаритные размеры

	S1BCH-107-FL	Complete unit float
	S1BCH-107-HD	Complete unit held
	PH-1	Housing designation
A	2,375 in	Center height
C	2,375 in	Base width
D	0,875 in	Base height
E <sub>min</sub>	6,75 in	Base hole distance 1 min
E <sub>max</sub>	7,5 in	Base hole distance 1 max
S	2	# of mounting bolts
S	0,5 in	Mounting bolt diameter
	S1BC-107-FL	Cartridge float bearing
	S1BC-107-HD	Cartridge held bearing
	S1C-108	Cartridge
G	3,312 in	Length through bore
L	3,938 in	Outside diameter cartridge
	124,9 lbs	Grease capacity
	6,9 lbs	Cartridge weight
	S1B-107-FL	Bearing float
	S1B-107-HD	Bearing held
	2,3 lbs	Bearing weight
	108 Grp	Housing group
C <sub>r</sub>	13.777 lbf	Динамическая грузоподъемность, радиальная
C <sub>0r</sub>	15.456 lbf	Статическая грузоподъемность, радиальная
C <sub>a</sub>	283 lbf	Динамическая грузоподъемность, осевая
	5.420 1/min	Limiting speed
D <sub>0</sub>	3,313 in	Outside diameter bearing
C <sub>0</sub>	1,972 in	Width inner ring
B <sub>0</sub>	0,938 in	Width outer ring





Просмотреть сведения о продукте на medias

10.07.2026, 23:11:46 UTC

SCHAEFFLER

