



**FAG**

## **BND3236-H-C-Y-BF-D** [↗](#)

Housing body

For bearings with a conical bore and clamping sleeve with set shaft,BND

### Teknik bilgiler

#### Main Dimensions & Performance Data

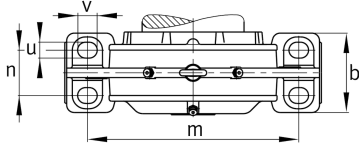

d 1	160 mm	Shaft diameter
a	680 mm	Length base
h 1	425 mm	Total height
g 1	240 mm	Total width with lid g1
g 2	274 mm	Total width with lid g2
≈m	50 kg	Bec

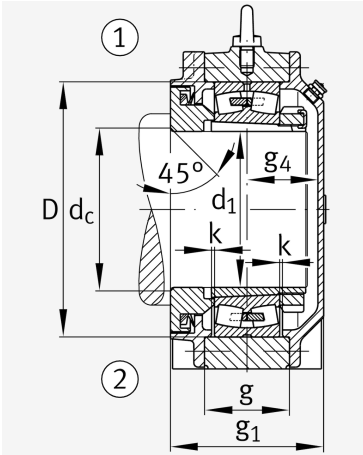
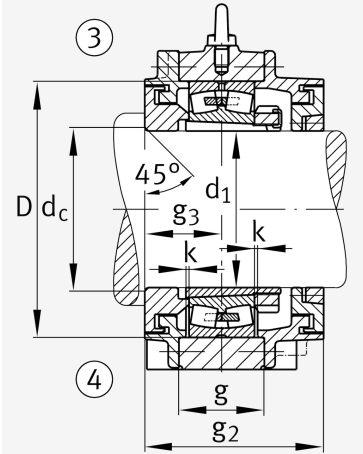
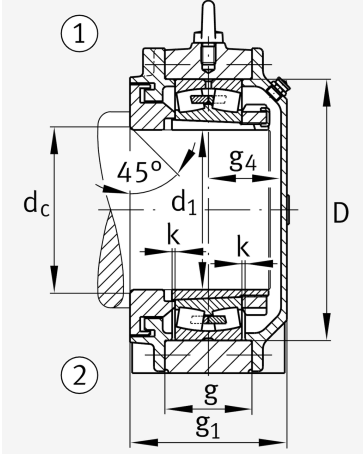
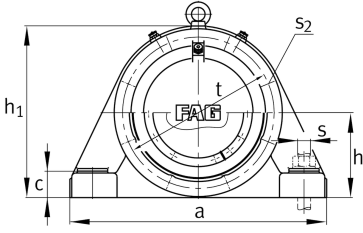

### Dimensions

	45 °	Chamfer angle
b	210 mm	Width base
c	65 mm	Height base foot
D	320 mm	Outside Diameter
d <sub>c</sub>	176 mm	Chamfer diameter c
d <sub>z</sub>	176 mm	Chamfer diameter dz
g	138 mm	Width housing body
g <sub>3</sub>	127 mm	Locking collar width g3
g <sub>4</sub>	105 mm	Locking collar width g4
h	210 mm	Distance shaft axis
k	3 mm	Axial displacement
m	550 mm	Distance fixing bore
n	120 mm	Bore distance width
s	M30	Size of fixing screws
s <sub>2</sub>	M16	Thread fixing bore
s <sub>2</sub>	8	Number of screwing holes
t	370 mm	Pitch circle dia fixing holes
u	36 mm	Width oblong holes
v	45 mm	Lenght oblong hole

### Additional information

H2336(-HG)	Adaptive Sleeve
23236.-K	Bearing designation

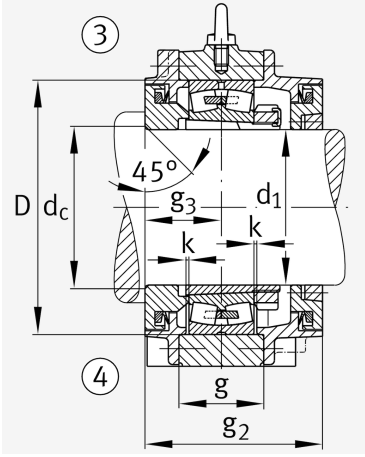

### Temperature range

$T_{min}$  -20 °C Operating temperature min.

$T_{max}$  100 °C Operating temperature max.