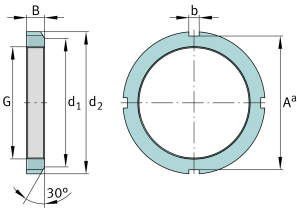

**FAG****KM10**

Locknut

Locknuts KM, main dimensions to DIN 981

Technical information

**Main Dimensions & Performance Data**

G	M50x1,5	Thread
d ₂	70 mm	Outerside diameter
B	11 mm	Width
≈m	158 g	Weight

Mounting dimensions

d ₁	61 mm	Chamfer diameter
b	6 mm	Width retaining slot
A ^a	65 mm	Groove base distance

Additional information

F	93.000 N	Axial load capacity, static
	MB10	Fuse
	30 °	Chamfer angle