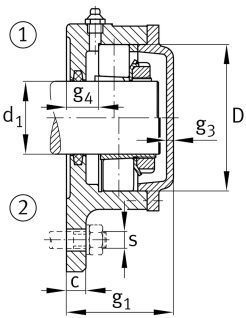
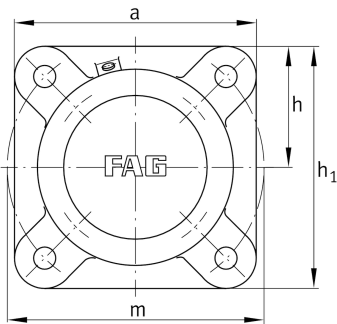

**FAG****F518-A-L**

Flanged housing

Flanged housing for various bearing types,
with conical bore and clamping sleeve, closed
on one side

Technical information

**Main Dimensions & Performance Data**

d_1	80 mm	Shaft diameter
a	210 mm	Flange width
h_1	210 mm	Height flange
	4	Number of fastening holes

$\approx m$	12,5 kg	Weight
-------------	---------	--------

Dimensions

	M10x1	Connection thread for lubrication
c	25 mm	Thickness of flange
D	160 mm	Outside diameter bearing
g_4	29 mm	Distance flange to bearing seat
h	105 mm	Distance shaft axis
m	240 mm	Pich circle diameter fixing holes
s	M16	Size of fixing screws