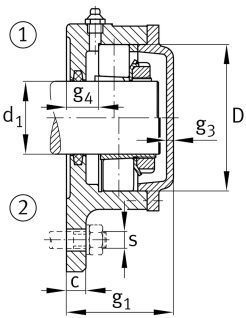
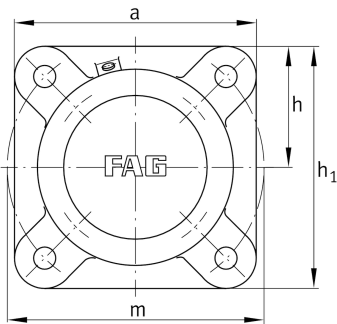

**FAG****F515-A-L**

## Flanged housing

Flanged housing for various bearing types,  
with conical bore and clamping sleeve, closed  
on one side

## Technical information

**Main Dimensions & Performance Data**

$d_1$	65 mm	Shaft diameter
$a$	190 mm	Flange width
$h_1$	190 mm	Height flange
	4	Number of fastening holes
$\approx m$	9,5 kg	Weight

**Dimensions**

	M10x1	Connection thread for lubrication
$c$	25 mm	Thickness of flange
$D$	130 mm	Outside diameter bearing
$g_4$	30 mm	Distance flange to bearing seat
$h$	95 mm	Distance shaft axis
$m$	215 mm	Pich circle diameter fixing holes
$s$	M16	Size of fixing screws