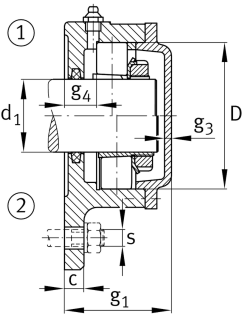

**FAG****F506-A-L**

Flanged housing

Flanged housing for various bearing types,
with conical bore and clamping sleeve, closed
on one side

Technical information

**Main Dimensions & Performance Data**

d_1	25 mm	Shaft diameter
a	130 mm	Flange width
h_1	117 mm	Height flange
	3	Number of fastening holes
$\approx m$	1,6 kg	Weight

Dimensions

	M10x1	Connection thread for lubrication
c	12 mm	Thickness of flange
D	62 mm	Outside diameter bearing
g_4	18 mm	Distance flange to bearing seat
h	44 mm	Distance shaft axis
m	116 mm	Pich circle diameter fixing holes
s	M10	Size of fixing screws