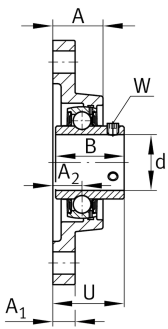

**FAG****UCFL215-48**

Flanged housing unit

Flanged housing unit UCFL

Technical information

**Your current product variant**

Material	GG	Grey cast iron
----------	----	----------------

Main Dimensions & Performance Data

d	76,2 mm	Bore diameter
L	165 mm	Flange width
H	275 mm	Height flange
U	78,5 mm	Total height unit
C _r	66.000 N	Basic dynamic load rating, radial
C _{0r}	44.500 N	Basic static load rating, radial
C _{ur}	2.300 N	Fatigue load limit, radial
≈m	5,62 kg	Weight

Mounting dimensions

J	225 mm	Distance fixing bore
N	23 mm	Fixing bore
n	2	Number of screwing holes



Dimensions

A	56 mm	Height housing
A ₁	24 mm	Thickness of flange
A ₂	34 mm	Distance raceway
B	77,8 mm	Width
Q	M6	Connection thread for lubrication

Additional information

1	Number of housings
FL215	Housing
UC215-48	Bearing designation

Temperature range

T _{min}	-20 °C	Operating temperature min.
T _{max}	120 °C	Operating temperature max.