

**LR5207-2HRS-TVH-XL**

Yoke type track roller

Yoke type track rollers LR52...2HRS-TVH-XL, double row self-retaining angular contact ball bearings with particularly thick-walled outer ring, ball and cage assembly and an inner ring, axial guidance of outer ring is provided by the balls, lubrication hole in inner ring on request, lip seal on both sides with optimised geometry, low friction, cage made from glass fibre reinforced polyamide, X-life design

X-life

Technical information

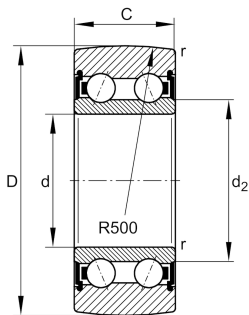

Your current product variant

Sealing	2HRS	Lip seal on both sides with optimised geometry, low friction
Outer ring profile	R500	R500
Cage	TVH	Solid cage made of glass-fiber reinforced polyamid PA66

Main Dimensions & Performance Data

D	80 mm	Outside diameter
d	35 mm	Bore diameter
C	27 mm	Height
C_{rw}	32.500 N	Effective dynamic load rating, radial
C_{0rw}	27.500 N	Effective static load rating, radial
C_{urw}	1.450 N	Effective fatigue limit load, radial
n_{DG}	3.100 1/min	Speed on permanent grease lubrication
F_{rper}	22.200 N	Permissible dynamic load, radial
m	0,66 kg	Weight

Dimensions

d_2	47 mm	Diameter of thrust washer
r_{min}	1,1 mm	Minimum chamfer dimension
R	500 mm	Radius of outer ring outside profile



Characteristics



Radial load



Axial load in one direction



Axial load in two directions



Lifetime lubrication, freedom from maintenance



Grease Lubrication



Sealed on both sides