

**LR5203-2HRS-TVH-XL**

## Yoke type track roller

Yoke type track rollers LR52...-2HRS-TVH-XL, double row self-retaining angular contact ball bearings with particularly thick-walled outer ring, ball and cage assembly and an inner ring, axial guidance of outer ring is provided by the balls, lubrication hole in inner ring on request, lip seal on both sides with optimised geometry, low friction, cage made from glass fibre reinforced polyamide, X-life design

X-life

## Technical information

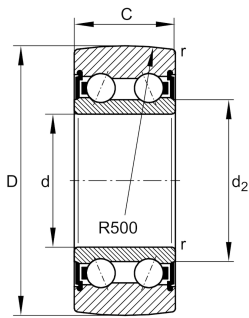

## Your current product variant

Sealing	2HRS	Lip seal on both sides with optimised geometry, low friction
Outer ring profile	R500	R500
Relubrication facility	Without	Without
Cage	TVH	Solid cage made of glass-fiber reinforced polyamid PA66

## Main Dimensions &amp; Performance Data







D	47 mm	Outside diameter
d	17 mm	Bore diameter
C	17,5 mm	Height
$C_{r w}$	13.700 N	Effective dynamic load rating, radial
$C_{0 r w}$	10.100 N	Effective static load rating, radial
$C_{u r w}$	510 N	Effective fatigue limit load, radial
$n_{D G}$	6.300 1/min	Speed on permanent grease lubrication
$F_{r per}$	10.100 N	Permissible dynamic load, radial
$\approx m$	0,17 kg	Weight



### Dimensions

$d_2$	24,4 mm	Diameter of thrust washer
$r_{min}$	0,6 mm	Minimum chamfer dimension
R	500 mm	Radius of outer ring outside profile

### Characteristics

-  Radial load
-  Axial load in one direction
-  Axial load in two directions
-  Lifetime lubrication, freedom from maintenance
-  Grease Lubrication
-  Sealed on both sides