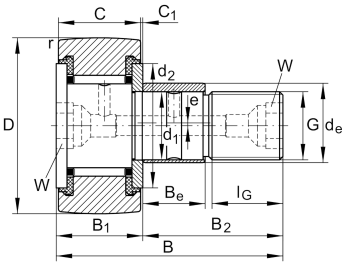
**KRE72-PP** **Stud type track roller**

Stud type track rollers KRE...-PP-A, single row needle roller bearings with particularly thick-walled outer ring, needle roller and cage assembly and a solid roller stud with fixing thread and a mounting aid, axial guidance of outer ring is provided by the plastic axial plain washers, contact flange and contact washer, three-stage sealing by plastic axial plain washer on both sides, with eccentric collar

Technical information

**Your current product variant**

Sealing	PP	Three-stage sealing by plastic axial plain washer on both sides
Outer ring profile	IOP	Optimized INA-profile
Grease nipples	2x	Drive-fit lubrication nipple unmounted 2x
Assembling aid head	I6	Hexagon socket
Assembling aid stud	I6	Hexagon socket

Main Dimensions & Performance Data

D	72 mm	Outside diameter
d ₁	24 mm	Fit diameter of roller stud / stud
B	80 mm	Width
C _{r w}	28.000 N	Basic dynamic load rating, radial
C _{0r w}	53.000 N	Basic static load rating, radial
C _{ur w}	7.300 N	Fatigue load limit, radial
n _{D G}	1.900 1/min	Speed on permanent grease lubrication
≈m	1,024 kg	Weight



Dimensions

B ₁	30,6 mm	Width of thrust washer
B ₂	49,5 mm	Bolt/stud length effectively
B ₃	11 mm	Distance to lubrication hole
C	29 mm	Width, outer ring
C ₁	0,8 mm	Protrusion outer ring to thrust washer
r _{min}	1,1 mm	Minimum chamfer dimension
d ₂	44 mm	Stop diameter of thrust washer
d ₃	4 mm	Diameter lubrication hole
G	M24X1,5	Thread
l _G	25 mm	Thread length
W	14 mm	Nominal dimension for hexagonal socket
d _e	28 mm	Diameter of eccentric
B _e	22 mm	Width, eccentric
e	1 mm	Eccentricity

Additional information

	NIPA3X9,5	Drive-fit lubrication nipple
M _A	220 Nm	Tightening torque nut

Characteristics



Radial load



Lifetime lubrication, freedom from maintenance



Grease Lubrication



Sealed on both sides