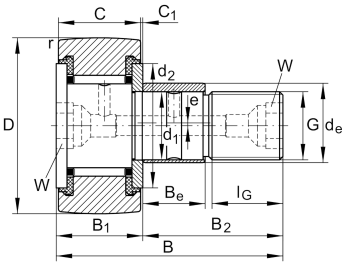
**KRE52-PP** **Stud type track roller**

Stud type track rollers KRE...-PP-A, single row needle roller bearings with particularly thick-walled outer ring, needle roller and cage assembly and a solid roller stud with fixing thread and a mounting aid, axial guidance of outer ring is provided by the plastic axial plain washers, contact flange and contact washer, three-stage sealing by plastic axial plain washer on both sides, with eccentric collar

## Technical information

**Your current product variant**

Sealing	PP	Three-stage sealing by plastic axial plain washer on both sides
Outer ring profile	IOP	Optimized INA-profile
Grease nipples	2x	Drive-fit lubrication nipple unmounted 2x
Assembling aid head	I6	Hexagon socket
Assembling aid stud	I6	Hexagon socket

**Main Dimensions & Performance Data**

D	52 mm	Outside diameter
d <sub>1</sub>	20 mm	Fit diameter of roller stud / stud
B	66 mm	Width
C <sub>r w</sub>	16.700 N	Basic dynamic load rating, radial
C <sub>0r w</sub>	29.500 N	Basic static load rating, radial
C <sub>ur w</sub>	3.850 N	Fatigue load limit, radial
n <sub>D G</sub>	2.400 1/min	Speed on permanent grease lubrication
≈m	0,49 kg	Weight







## Dimensions

B <sub>1</sub>	25,6 mm	Width of thrust washer
B <sub>2</sub>	40,5 mm	Bolt/stud length effectively
B <sub>3</sub>	9 mm	Distance to lubrication hole
C	24 mm	Width, outer ring
C <sub>1</sub>	0,8 mm	Protrusion outer ring to thrust washer
r <sub>min</sub>	1 mm	Minimum chamfer dimension
d <sub>2</sub>	36,5 mm	Stop diameter of thrust washer
d <sub>3</sub>	4 mm	Diameter lubrication hole
G	M20X1,5	Thread
l <sub>G</sub>	21 mm	Thread length
W	10 mm	Nominal dimension for hexagonal socket
d <sub>e</sub>	24 mm	Diameter of eccentric
B <sub>e</sub>	18 mm	Width, eccentric
e	1 mm	Eccentricity

## Additional information

	NIPA2X7,5	Drive-fit lubrication nipple
M <sub>A</sub>	120 Nm	Tightening torque nut

## Characteristics

-  Radial load
-  Lifetime lubrication, freedom from maintenance
-  Grease Lubrication
-  Sealed on both sides