**KRE30-PP**

Stud type track roller

Stud type track rollers KRE...-PP-A, single row needle roller bearings with particularly thick-walled outer ring, needle roller and cage assembly and a solid roller stud with fixing thread and a mounting aid, axial guidance of outer ring is provided by the plastic axial plain washers, contact flange and contact washer, three-stage sealing by plastic axial plain washer on both sides, with eccentric collar

Technical information

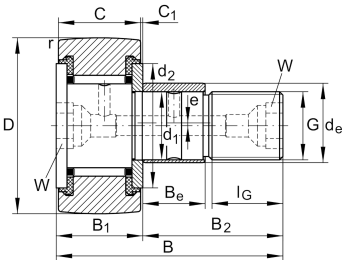

Your current product variant

Sealing	PP	Three-stage sealing by plastic axial plain washer on both sides
Outer ring profile	IOP	Optimized INA-profile
Grease nipples	2x	Drive-fit lubrication nipple unmounted 2x
Assembling aid head	I6	Hexagon socket
Assembling aid stud	I6	Hexagon socket

Main Dimensions & Performance Data

D	30 mm	Outside diameter
d ₁	12 mm	Fit diameter of roller stud / stud
B	40 mm	Width
C _{r w}	6.800 N	Basic dynamic load rating, radial
C _{0r w}	8.700 N	Basic static load rating, radial
C _{ur w}	1.240 N	Fatigue load limit, radial
n _{D G}	5.500 1/min	Speed on permanent grease lubrication
≈m	89,5 g	Weight



Dimensions

B ₁	15,2 mm	Width of thrust washer
B ₂	25 mm	Bolt/stud length effectively
B ₃	6 mm	Distance to lubrication hole
C	14 mm	Width, outer ring
C ₁	0,6 mm	Protrusion outer ring to thrust washer
r _{min}	0,6 mm	Minimum chamfer dimension
d ₂	23 mm	Stop diameter of thrust washer
d ₃	3 mm	Diameter lubrication hole
G	M12X1,5	Thread
l _G	13 mm	Thread length
W	6 mm	Nominal dimension for hexagonal socket
d _e	15 mm	Diameter of eccentric
B _e	11 mm	Width, eccentric
e	0,5 mm	Eccentricity

Additional information

	NIPA1X4,5	Drive-fit lubrication nipple
M _A	22 Nm	Tightening torque nut

Characteristics



Radial load



Lifetime lubrication, freedom from maintenance



Grease Lubrication



Sealed on both sides