**NATV30**

Yoke type track roller

Yoke type track rollers NATV..., single row needle roller bearings with particularly thick-walled outer ring, full complement needle roller set and an inner ring, axial guidance of outer ring is provided by the contact washers, gap seals on both sides

Technical information

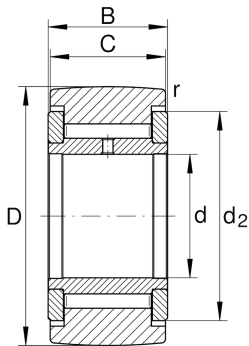

Your current product variant

Sealing	SPSP	Gap seal on both sides
Outer ring profile	R500	R500

Main Dimensions & Performance Data

d	30 mm	Bore diameter
D	62 mm	Outside diameter
B	29 mm	Width of the bearing
C_{rw}	30.000 N	Basic dynamic load rating, radial
C_{0rw}	63.000 N	Basic static load rating, radial
C_{urw}	9.000 N	Fatigue load limit, radial
n_{DG}	850 1/min	Speed on permanent grease lubrication
F_{0rper}	63.000 N	Permissible static load, radial
F_{rper}	55.000 N	Permissible dynamic load outer ring, radial
$\approx m$	498,45 g	Weight

Dimensions

C	28 mm	Width, outer ring
d_2	51 mm	Outside diameter of thrust washer
r_{min}	1 mm	Minimum chamfer dimension
R	500 mm	Radius of outer ring outside profile



Characteristics



Radial load



Grease Lubrication



Oil Lubrication



Not sealed