**NATV20**

## Yoke type track roller

Yoke type track rollers NATV..., single row needle roller bearings with particularly thick-walled outer ring, full complement needle roller set and an inner ring, axial guidance of outer ring is provided by the contact washers, gap seals on both sides

## Technical information

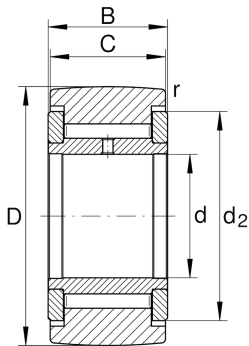

## Your current product variant

Sealing	SPSP	Gap seal on both sides
Outer ring profile	R500	R500

## Main Dimensions &amp; Performance Data

d	20 mm	Bore diameter
D	47 mm	Outside diameter
B	25 mm	Width of the bearing
$C_{r w}$	20.200 N	Basic dynamic load rating, radial
$C_{0r w}$	42.500 N	Basic static load rating, radial
$C_{ur w}$	6.000 N	Fatigue load limit, radial
$n_{D G}$	1.300 1/min	Speed on permanent grease lubrication
$F_{0r per}$	42.500 N	Permissible static load, radial
$F_{r per}$	42.500 N	Permissible dynamic load outer ring, radial
$\approx m$	0,255 kg	Weight

## Dimensions

C	24 mm	Width, outer ring
$d_2$	36,5 mm	Outside diameter of thrust washer
$r_{min}$	1 mm	Minimum chamfer dimension
R	500 mm	Radius of outer ring outside profile



### Characteristics

---



Radial load



Grease Lubrication



Oil Lubrication



Not sealed