**NATV15**

Yoke type track roller

Yoke type track rollers NATV..., single row needle roller bearings with particularly thick-walled outer ring, full complement needle roller set and an inner ring, axial guidance of outer ring is provided by the contact washers, gap seals on both sides

Technical information

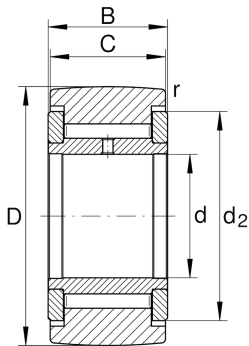

Your current product variant

Sealing	SPSP	Gap seal on both sides
Outer ring profile	R500	R500

Main Dimensions & Performance Data

d	15 mm	Bore diameter
D	35 mm	Outside diameter
B	19 mm	Width of the bearing
$C_{r w}$	12.700 N	Basic dynamic load rating, radial
$C_{0 r w}$	23.400 N	Basic static load rating, radial
$C_{u r w}$	3.250 N	Fatigue load limit, radial
$n_{D G}$	1.600 1/min	Speed on permanent grease lubrication
$F_{0 r per}$	23.400 N	Permissible static load, radial
$F_{r per}$	21.500 N	Permissible dynamic load outer ring, radial
m	0,105 kg	Weight

Dimensions

C	18 mm	Width, outer ring
d_2	27,6 mm	Outside diameter of thrust washer
r_{min}	0,6 mm	Minimum chamfer dimension
R	500 mm	Radius of outer ring outside profile



Characteristics



Radial load



Grease Lubrication



Oil Lubrication



Not sealed