

**NATR6-PP**

## Yoke type track roller

Yoke type track rollers NATR...-PP-A, single row needle roller bearings with particularly thick-walled outer ring, needle roller and cage assembly and an inner ring, axial guidance of outer ring is provided by the plastic axial plain washers and contact washers, three-stage sealing by plastic axial plain washer on both sides

## Technical information

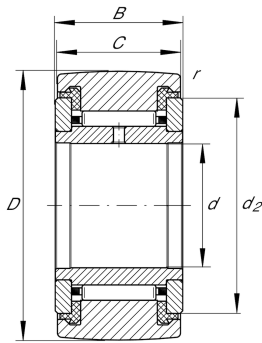

## Your current product variant

Sealing	PP	Three-stage sealing by plastic axial plain washer on both sides
Outer ring profile	IOP	Optimized INA-profile
Relubrication facility	IR	Via inner ring

## Main Dimensions &amp; Performance Data

d	6 mm	Bore diameter
D	19 mm	Outside diameter
B	12 mm	Width of the bearing
$C_{rW}$	3.550 N	Basic dynamic load rating, radial
$C_{0rW}$	4.100 N	Basic static load rating, radial
$C_{urW}$	560 N	Fatigue load limit, radial
$n_{DG}$	11.000 1/min	Speed on permanent grease lubrication
$F_{0rper}$	4.100 N	Permissible static load, radial
$F_{rper}$	4.100 N	Permissible dynamic load outer ring, radial
$\approx m$	19,158 g	Weight

## Dimensions

C	11 mm	Width, outer ring
$d_2$	15 mm	Outside diameter of thrust washer
$r_{min}$	0,15 mm	Minimum chamfer dimension



### Characteristics

---



Radial load



Lifetime lubrication, freedom from maintenance



Grease Lubrication



Sealed on both sides