

**NKX25-Z-XL**

## Needle roller/axial ball bearing

Needle roller/axial ball bearings NKX...-Z, axial component, single direction, to DIN 5429, with end cap, for grease lubrication

X-life

## Technical information

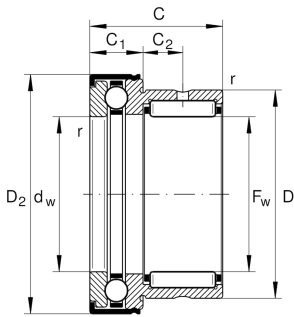

## Your current product variant

Sealing	Z	Bearing with end cap
Cage	Standard	

## Main Dimensions &amp; Performance Data

$F_w$	25 mm	Bore diameter
D	37 mm	Outside diameter
C	30 mm	Height
$C_r$	21.300 N	Basic dynamic load rating, radial
$C_{0r}$	30.500 N	Basic static load rating, radial
$C_a$	19.600 N	Basic dynamic load rating, axial
$C_{0a}$	37.500 N	Basic static load rating, axial
$C_{ur}$	5.400 N	Fatigue load limit, radial
$C_{ua}$	1.840 N	Fatigue load limit, axial
$n_G$	6.000 1/min	Limiting speed
$\approx m$	129,13 g	Weight

## Mounting dimensions

$d_a$	37,7 mm	Mounting dimension shaft shoulder
$r_{a \max}$	0,6 mm	Maximum recess radius



## Dimensions

D 1 max	43,2 mm	Maximum outside diameter flange
D 2 max	43,2 mm	Maximum outside diameter flange
C 1	11 mm	Width of the axial bearing component
C 1	9,5 mm	Distance to lubrication hole
C 2	9,5 mm	Distance to lubrication hole
d w	25 mm	Bore diameter of shaft washer
r min	0,6 mm	Minimum chamfer dimension

## Temperature range

T min	-30 °C	Operating temperature min.
T max	120 °C	Operating temperature max.

## Additional information

IR20X25X20-XL

Suitable inner rings IR

## Characteristics

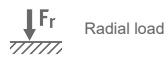

Radial load

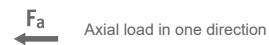

Axial load in one direction



Grease Lubrication

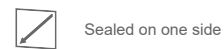

Sealed on one side