

**NKX20-Z-XL**

Needle roller/axial ball bearing

Needle roller/axial ball bearings NKX...-Z, axial component, single direction, to DIN 5429, with end cap, for grease lubrication

X-life

Technical information

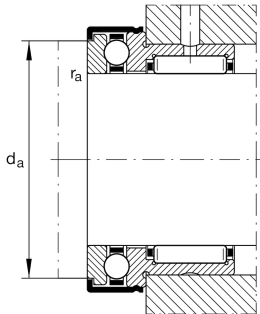
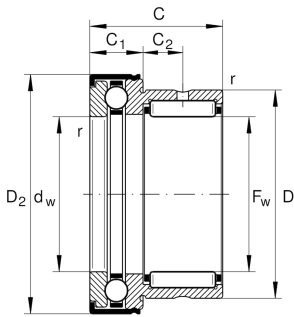

Your current product variant

Sealing	Z	Bearing with end cap
Cage	Standard	

Main Dimensions & Performance Data

F_w	20 mm	Bore diameter
D	30 mm	Outside diameter
C	30 mm	Height
C_r	18.600 N	Basic dynamic load rating, radial
C_{0r}	23.800 N	Basic static load rating, radial
C_a	14.200 N	Basic dynamic load rating, axial
C_{0a}	24.700 N	Basic static load rating, axial
C_{ur}	4.200 N	Fatigue load limit, radial
C_{ua}	1.220 N	Fatigue load limit, axial
n_G	7.500 1/min	Limiting speed
$\approx m$	85,14 g	Weight

Mounting dimensions

d_a	30,7 mm	Mounting dimension shaft shoulder
$r_{a \max}$	0,3 mm	Maximum recess radius



Dimensions

D 1 max	36,2 mm	Maximum outside diameter flange
D 2 max	36,2 mm	Maximum outside diameter flange
C 1	10 mm	Width of the axial bearing component
C 1	10,5 mm	Distance to lubrication hole
C 2	10,5 mm	Distance to lubrication hole
d w	20 mm	Bore diameter of shaft washer
r min	0,3 mm	Minimum chamfer dimension

Temperature range





T min	-30 °C	Operating temperature min.
T max	120 °C	Operating temperature max.

Additional information

IR17X20X20-XL

Suitable inner rings IR

Characteristics

-  Radial load
-  Axial load in one direction
-  Grease Lubrication
-  Sealed on one side