

**NKX10-Z-TV-XL** [↗](#)

## Needle roller/axial ball bearing

Needle roller/axial ball bearings NKX...-Z, axial component, single direction, to DIN 5429, with end cap, for grease lubrication

X-life

## Technical information

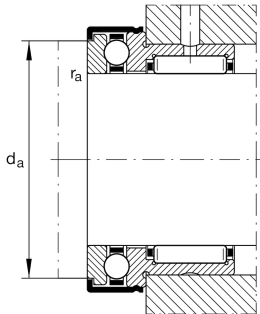
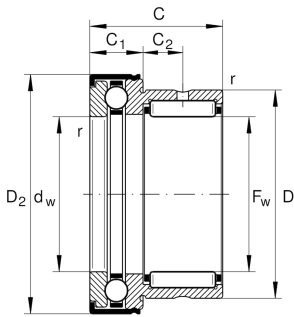

## Your current product variant

Sealing	Z	Bearing with end cap
Cage	TV	Plastic Cage made from PA66

## Main Dimensions &amp; Performance Data

$F_w$	10 mm	Bore diameter
D	19 mm	Outside diameter
C	23 mm	Height
$C_r$	7.000 N	Basic dynamic load rating, radial
$C_{0r}$	7.800 N	Basic static load rating, radial
$C_a$	10.000 N	Basic dynamic load rating, axial
$C_{0a}$	14.000 N	Basic static load rating, axial
$C_{ur}$	1.330 N	Fatigue load limit, radial
$C_{ua}$	690 N	Fatigue load limit, axial
$n_G$	12.400 1/min	Limiting speed
$\approx m$	39 g	Weight

## Mounting dimensions

$d_a$	19,7 mm	Mounting dimension shaft shoulder
$r_{a \max}$	0,3 mm	Maximum recess radius



## Dimensions

D 1 max	25,2 mm	Maximum outside diameter flange
D 2 max	25,2 mm	Maximum outside diameter flange
C 1	9 mm	Width of the axial bearing component
C 1	6,5 mm	Distance to lubrication hole
C 2	6,5 mm	Distance to lubrication hole
d w	10 mm	Bore diameter of shaft washer
r min	0,3 mm	Minimum chamfer dimension

## Temperature range

T min	-30 °C	Operating temperature min.
T max	120 °C	Operating temperature max.

## Additional information

IR7X10X16-XL

Suitable inner rings IR

## Characteristics

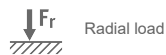

Radial load

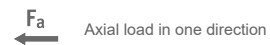

Axial load in one direction



Grease Lubrication

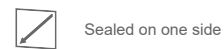

Sealed on one side