

**81296-M**

Axial cylindrical roller bearing

Axial cylindrical roller bearing 812...-M, single row



Technical information

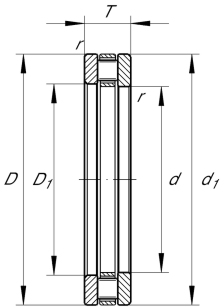

Your current product variant

Cage	M	Brass Cage
------	---	------------

Main Dimensions & Performance Data

d	480 mm	Bore diameter
T	135 mm	Height
C _a	4.200.000 N	Basic dynamic load rating, axial
C _{0a}	17.400.000 N	Basic static load rating, axial
C _{ua}	1.230.000 N	Fatigue load limit, axial
n _G	510 1/min	Limiting speed
n _{gr}	141 1/min	Reference speed
D	650 mm	Outside diameter
m	148,6 kg	Weight

Mounting dimensions

d _{a min}	637 mm	Minimum diameter shaft shoulder
D _{a max}	518 mm	Maximum diameter of housing shoulder
r _{a max}	5 mm	Maximum recess radius



Dimensions

D ₁	485 mm	Bore diameter housing washer
d ₁	645 mm	Rip diameter shaft washer
r _{min}	5 mm	Minimum chamfer dimension

Temperature range

T _{min}	-30 °C	Operating temperature min.
T _{max}	120 °C	Operating temperature max.

Additional information

K81296-M	Axial roller and cage assembly
GS81296	Housing Washer
WS81296	Shaft washer

Characteristics

-  Axial load in one direction
-  Grease Lubrication
-  Oil Lubrication
-  Not sealed