**ZKLFA1263-2Z**

## Axial angular contact ball bearing

Angular contact ball bearing units  
ZKLFA.-2Z, double direction, for screw  
mounting, gap seals on both sides

## Technical information

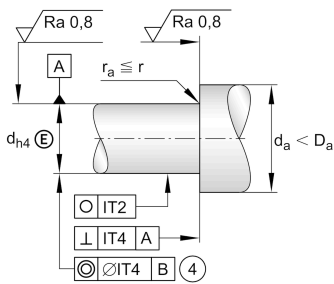
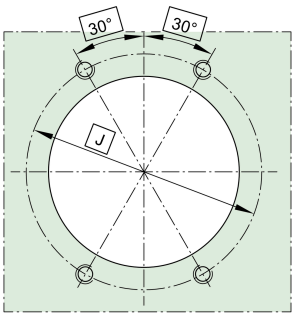
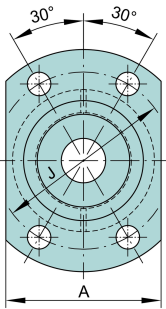

## Your current product variant

Sealing	2Z	Minimal gap seal on both sides
---------	----	--------------------------------

## Main Dimensions &amp; Performance Data

d	12 mm	Bore diameter
	0 mm	Bore diameter upper tolerance
	-0,005 mm	Bore diameter lower tolerance
D	42 mm	Outside diameter
	0 mm	Outside diameter upper tolerance
	-0,01 mm	Outside diameter lower tolerance
B	25 mm	Width
	0 mm	Width upper tolerance
	-0,25 mm	Width lower tolerance
C <sub>a</sub>	17.100 N	Basic dynamic load rating, axial
C <sub>0a</sub>	25.000 N	Basic static load rating, axial
C <sub>ua</sub>	1.140 N	Fatigue load limit, axial
n <sub>G</sub> Grease	12.000 1/min	Limiting speed for grease lubrication
n <sub>g</sub>	7.600 1/min	Thermally permissible speed
≈m	0,277 kg	Weight

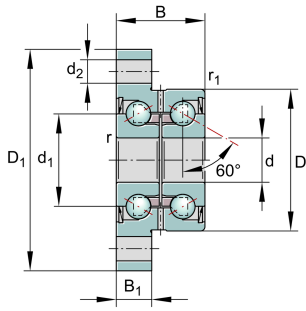

### Mounting dimensions

$d_{a \min}$	16 mm	Minimum diameter shaft shoulder
$d_{a \max}$	31 mm	Maximum diameter of shaft shoulder
$t_1$	0,1 mm	Position tolerance
	M6	Screw size

$n_a$	4	Number of screws
-------	---	------------------

### Dimensions

$d_1$	25 mm	Rib diameter inner ring
-------	-------	-------------------------

$r_{\min}$	0,3 mm	Minimum chamfer dimension
------------	--------	---------------------------

$r_{1 \min}$	0,6 mm	Minimum chamfer dimension
--------------	--------	---------------------------

$B_1$	10 mm	Thickness of flange
-------	-------	---------------------

$d_2$	6,8 mm	Fixing boring diameter
-------	--------	------------------------

J	53 mm	Pitch circle diameter (holes)
---	-------	-------------------------------

A	45 mm	Flange width
---	-------	--------------

### Temperature range

$T_{\min}$	-30 °C	Operating temperature min.
------------	--------	----------------------------

$T_{\max}$	120 °C	Operating temperature max.
------------	--------	----------------------------

### Additional information

$M_{RL}$	0,08 Nm	Bearing friction torque
----------	---------	-------------------------

$c_{aL}$	375 N/ $\mu$ m	Rigidity axial
----------	----------------	----------------

$c_{kL}$	50 Nm/mrad	Tilting stiffness
----------	------------	-------------------

$M_m$	0,068 kg*cm <sup>2</sup>	Mass moment of inertia
-------	--------------------------	------------------------

	2 $\mu$ m	Axial runout
--	-----------	--------------

	ZM12	Recommended INA precision locknut for radial locking (not included)
--	------	---------------------------------------------------------------------

$M_A$	8 Nm	Tightening torque nut
-------	------	-----------------------

	5.307 N	Locknut force axial
--	---------	---------------------



### Characteristics

---



Radial load



Axial load in one direction



Axial load in two directions



Lifetime lubrication, freedom from maintenance



Grease Lubrication



Sealed on both sides