

**FAG****51409**

Axial deep groove ball bearing

Axial deep groove ball bearing 514, single direction, steel sheet metal cage

Technical information

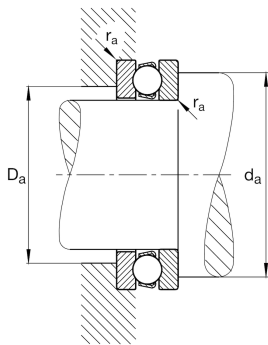

Your current product variant

Cage	JP	Steel sheet metal
Tolerance class	PN	Normal (ISO 492:2023)
Dimensional / heat stabilization	S0	Rings dimensional stabilized up to 150°

Main Dimensions & Performance Data

d	45 mm	Inner diameter shaft washer
D	100 mm	Outer diameter housing washer
T	39 mm	Height
C_a	123.000 N	Basic dynamic load rating, axial
C_{0a}	222.000 N	Basic static load rating, axial
C_{ua}	10.100 N	Fatigue load limit, axial
n_G	2.850 1/min	Limiting speed
n_{gr}	6.900 1/min	Reference speed
$\approx m$	1,424 kg	Weight

Mounting dimensions

$d_{a \min}$	78 mm	Minimum diameter shaft shoulder
$D_{a \max}$	67 mm	Maximum diameter of housing shoulder
$r_{a \max}$	1 mm	Maximum filled radius



Dimensions

r_{min}	1,1 mm	Minimum chamfer dimension
D_1	47 mm	Inner diameter housing washer
d_1	100 mm	Outer diameter shaft washer

Temperature range

T_{min}	-30 °C	Operating temperature min.
T_{max}	150 °C	Operating temperature max.

Calculation factors

A	0,29	Minimum load factor
---	------	---------------------

Characteristics

-  F_a Axial load in one direction
-  Grease Lubrication
-  Oil Lubrication
-  Not sealed