

**FAG****51408**

Axial deep groove ball bearing

Axial deep groove ball bearing 514, single direction, steel sheet metal cage

## Technical information

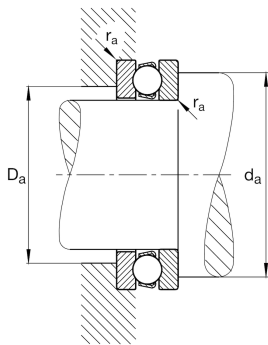
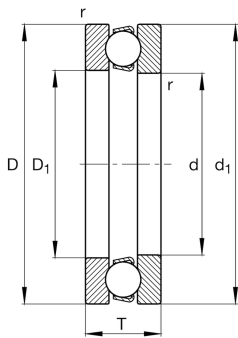

## Your current product variant

|                                  |    |   |
|----------------------------------|----|---|
| Cage                             | JP | Steel sheet metal                       |
| Tolerance class                  | PN | Tolerance class PN, acc. to DIN 620     |
| Dimensional / heat stabilization | S0 | Rings dimensional stabilized up to 150° |

## Main Dimensions &amp; Performance Data

|          |             |                                  |
|----------|-------------|----------------------------------|
| d        | 40 mm       | Inner diameter shaft washer      |
| D        | 90 mm       | Outer diameter housing washer    |
| T        | 36 mm       | Height                           |
| $C_a$    | 96.000 N    | Basic dynamic load rating, axial |
| $C_{0a}$ | 170.000 N   | Basic static load rating, axial  |
| $C_{ua}$ | 7.700 N     | Fatigue load limit, axial        |
| $n_G$    | 3.250 1/min | Limiting speed                   |
| $n_{gr}$ | 7.600 1/min | Reference speed                  |
| $m$      | 1,083 kg    | Weight                           |

## Mounting dimensions

|              |       |                                      |
|--------------|-------|--------------------------------------|
| $d_{a \min}$ | 70 mm | Minimum diameter shaft shoulder      |
| $D_{a \max}$ | 60 mm | Maximum diameter of housing shoulder |
| $r_{a \max}$ | 1 mm  | Maximum fillet radius                |



### Dimensions

|            |        |                               |
|------------|--------|-------------------------------|
| $r_{\min}$ | 1,1 mm | Minimum chamfer dimension     |
| $D_1$      | 42 mm  | Inner diameter housing washer |
| $d_1$      | 90 mm  | Outer diameter shaft washer   |

### Temperature range

|            |        |                            |
|------------|--------|----------------------------|
| $T_{\min}$ | -30 °C | Operating temperature min. |
| $T_{\max}$ | 150 °C | Operating temperature max. |

### Calculation factors

|   |      |                     |
|---|------|---------------------|
| A | 0,18 | Minimum load factor |
|---|------|---------------------|

### Characteristics

-  Axial load in one direction
-  Grease Lubrication
-  Oil Lubrication
-  Not sealed