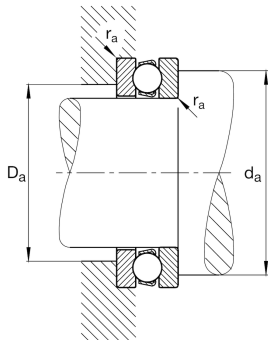

**FAG****51264-MP**

Axial deep groove ball bearing

Axial deep groove ball bearing 512...-MP,
single direction, solid brass cage

Technical information

**Your current product variant**

Cage	MP	Solid brass cage, rolling element guided
Tolerance class	PN	Normal (ISO 492:2023)
Dimensional / heat stabilization	S1	Rings dimensional stabilized up to 200°

Main Dimensions & Performance Data

d	320 mm	Inner diameter shaft washer
D	440 mm	Outer diameter housing washer
T	95 mm	Height
C _a	600.000 N	Basic dynamic load rating, axial
C _{0a}	2.800.000 N	Basic static load rating, axial
C _{ua}	65.000 N	Fatigue load limit, axial
n _G	940 1/min	Limiting speed
n _{gr}	1.080 1/min	Reference speed
m	44,12 kg	Weight

Mounting dimensions

d _{a min}	392 mm	Minimum diameter shaft shoulder
D _{a max}	368 mm	Maximum diameter of housing shoulder
r _{a max}	2,5 mm	Maximum filled radius



Dimensions

r_{\min}	3 mm	Minimum chamfer dimension
D_1	325 mm	Inner diameter housing washer
d_1	435 mm	Outer diameter shaft washer

Temperature range

T_{\min}	-30 °C	Operating temperature min.
T_{\max}	200 °C	Operating temperature max.

Calculation factors

A	43	Minimum load factor
---	----	---------------------

Characteristics

-  Axial load in one direction
-  Grease Lubrication
-  Oil Lubrication
-  Not sealed
-  Large bearing