

**FAG****51196-MP**

Axial deep groove ball bearing

Axial deep groove ball bearing 511..-MP,
single direction, solid brass cage

Technical information

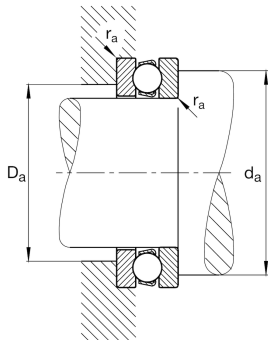

Your current product variant

Cage	MP	Solid brass cage, rolling element guided
Tolerance class	PN	Normal (ISO 492:2023)
Dimensional / heat stabilization	S1	Rings dimensional stabilized up to 200°

Main Dimensions & Performance Data

d	480 mm	Inner diameter shaft washer
D	580 mm	Outer diameter housing washer
T	80 mm	Height
C _a	540.000 N	Basic dynamic load rating, axial
C _{0a}	3.250.000 N	Basic static load rating, axial
C _{ua}	64.000 N	Fatigue load limit, axial
n _G	850 1/min	Limiting speed
n _{gr}	660 1/min	Reference speed
m	43,1 kg	Weight

Mounting dimensions

d _{a min}	540 mm	Minimum diameter shaft shoulder
D _{a max}	520 mm	Maximum diameter of housing shoulder
r _{a max}	2,1 mm	Maximum filled radius



Dimensions

r_{\min}	2,1 mm	Minimum chamfer dimension
D_1	484 mm	Inner diameter housing washer
d_1	575 mm	Outer diameter shaft washer





Temperature range

T_{\min}	-30 °C	Operating temperature min.
T_{\max}	200 °C	Operating temperature max.

Calculation factors

A	54	Minimum load factor
---	----	---------------------

Characteristics

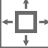
-  Axial load in one direction
-  Grease Lubrication
-  Oil Lubrication
-  Not sealed
-  Large bearing