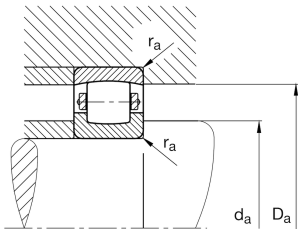

**FAG****20230-MB-C3**

Barrel roller bearing

Barrel roller bearing 202...-MB

Technical information

**Your current product variant**

Bore type	Z	Cylindrical
Cage	MB	Solid brass cage
Radial internal clearance	C3 (Group 3)	Internal clearance larger than CN

Main Dimensions & Performance Data

d	150 mm	Bore diameter
D	270 mm	Outside diameter
B	45 mm	Width
C_r	430.000 N	Basic dynamic load rating, radial
C_{0r}	610.000 N	Basic static load rating, radial
C_{ur}	56.000 N	Fatigue load limit, radial
n_G	2.850 1/min	Limiting speed
$\approx m$	11,6 kg	Weight

Mounting dimensions

$d_{a \min}$	164 mm	Minimum diameter shaft shoulder
$D_{a \max}$	256 mm	Maximum diameter of housing shoulder
$r_{a \max}$	2,5 mm	Maximum recess radius

Dimensions

r_{\min}	3 mm	Minimum chamfer dimension
D_1	238,6 mm	Bore diameter outer ring



Temperature range

T_{min}	-30 °C	Operating temperature min.
T_{max}	200 °C	Operating temperature max.

Characteristics

-  F_r Radial load
-  F_a Axial load in one direction
-  F_a Axial load in two directions
-  Grease Lubrication
-  Oil Lubrication
-  Not sealed
-  Static angular error and misalignment
-  Dynamic angular error and misalignment