



FAG

**21307-E1-XL-K-TVPB**

## Spherical Roller Bearing

Spherical roller bearings 213..-E1-K, main dimensions to DIN 635-2, with tapered bore, taper 1:12

X-life

## Technical information

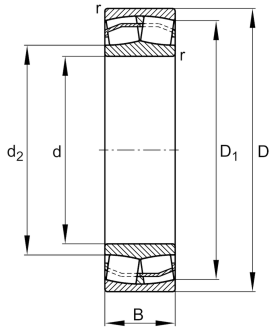

## Your current product variant

Design	E1	Without central rip
Cage	TVPB	Plastic cage
Radial internal clearance	CN (Group N)	Normal internal clearance
Relubrication facility	Without	Without lubricating groove and holes

## Main Dimensions &amp; Performance Data

d	35 mm	Bore diameter
D	80 mm	Outside diameter
B	21 mm	Width
$C_r$	83.000 N	Basic dynamic load rating, radial
$C_{0r}$	74.000 N	Basic static load rating, radial
$C_{ur}$	8.300 N	Fatigue load limit, radial
$n_G$	10.900 1/min	Limiting speed
$n_{gr}$	6.800 1/min	Reference speed
$m$	0,491 kg	Weight



### Mounting dimensions

$d_{a \min}$	44 mm	Minimum diameter shaft shoulder
$D_{a \max}$	71 mm	Maximum diameter of housing shoulder
$r_{a \max}$	1,5 mm	Maximum recess radius
$B_{a \min}$	8 mm	Minimum cavity width of the sleeve
$d_{a \max}$	47 mm	Maximum diameter of shaft shoulder
$d_{b \min}$	39 mm	Minimum cavity diameter of the sleeve

### Dimensions

$r_{\min}$	1,5 mm	Minimum chamfer dimension
$D_1$	66,6 mm	Bore diameter outer ring
$d_2$	47,4 mm	Raceway diameter of the inner ring

### Temperature range

$T_{\min}$	-30 °C	Operating temperature min.
$T_{\max}$	120 °C	Operating temperature max.

### Calculation factors

$e$	0,26	Limiting value of $F_a/F_r$ for the applicability of diff. Values of factors X and Y
$Y_1$	2,55	Dynamic axial load factor
$Y_2$	3,8	Dynamic axial load factor
$Y_0$	2,5	Static axial load factor

### Additional information

H307

Adapter sleeve



### Characteristics

---

-  Radial load
-  Axial load in one direction
-  Axial load in two directions
-  Grease Lubrication
-  Oil Lubrication
-  Not sealed
-  Static angular error and misalignment
-  Dynamic angular error and misalignment