



NA4922-XL [↗](#)

Игольчатый роликоподшипник

Needle roller bearing NA49...-XL, single row, with inner ring, outer ring with 2 bords

X-life

Техническая информация

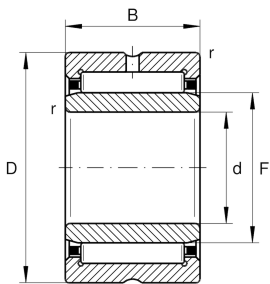

Ihre aktuelle Produktvariante

| | | |
|---------|----------|----------|
| Cage | Standard | Стандарт |
| Coating | Without | без |

Main Dimensions & Performance Data

| | | |
|-----------------|-------------|-----------------------------------|
| d | 110 mm | Bore diameter |
| D | 150 mm | Outside diameter |
| B | 40 mm | Width |
| C _r | 149.000 N | Basic dynamic load rating, radial |
| C _{0r} | 290.000 N | Basic static load rating, radial |
| C _{ur} | 48.000 N | Fatigue load limit, radial |
| n _G | 3.700 1/min | Limiting speed |
| n _{gr} | 2.330 1/min | Reference speed |
| ≈m | 2,081 kg | Gewicht |

Dimensions





| | | |
|------------------|--------|-----------------------------|
| F | 125 mm | Raceway diameter inner ring |
| r _{min} | 1,1 mm | Minimum chamfer dimension |
| s | 2 mm | Axial displacement |

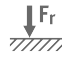

Temperature range

| | | |
|-----------|--------|----------------------------|
| T_{min} | -30 °C | Operating temperature min. |
| T_{max} | 120 °C | Operating temperature max. |

Eigenschaften

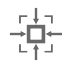
-  Radiale Last
-  Fettschmierung
-  Ölschmierung
-  Nicht abgedichtet
-  Kleiner Bauraum