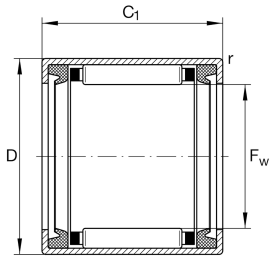

**HK1216-2RS-AS1-L271** [↗](#)

Drawn cup needle roller bearing open end

Drawn cup needle roller bearings with open ends HK..-2RS, lip seals on both sides, to DIN 618

## Technical information

**Your current product variant**

Lubricant	L271	Grease (L271/standart specific)
Lubrication hole	Without	
Coating	Without	
Sealing	2RS	Contact seal on both sides

**Main Dimensions & Performance Data**

$F_w$	12 mm	Under roller diameter
$D$	18 mm	Outside diameter
$C_r$	6.500 N	Basic dynamic load rating, radial
$C_{0r}$	7.300 N	Basic static load rating, radial
$C_{ur}$	880 N	Fatigue load limit, radial
$n_G$	12.000 1/min	Limiting speed
$n_G$ Grease	12.000 1/min	Limiting speed for grease lubrication
$\approx m$	11,17 g	Weight

**Dimensions**

$C_1$	16 mm	Width, outer ring
$r_{min}$	0,8 mm	Minimum chamfer dimension

**Temperature range**

$T_{min}$	-20 °C	Operating temperature min.
$T_{max}$	100 °C	Operating temperature max.



### Additional information

---

IR9X12X16-XL

Suitable inner rings IR

### Characteristics

---



Radial load



Grease Lubrication



Sealed on both sides



Small design envelope