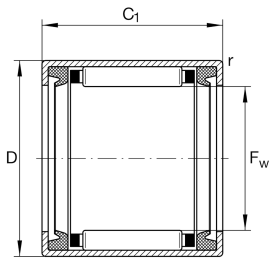

**HK2520-2RS**

Drawn cup needle roller bearing open end

Drawn cup needle roller bearings with open ends HK...-2RS, lip seals on both sides, to DIN 618

Technical information

**Your current product variant**

Lubricant	L271	Grease (L271/standart specific)
Lubrication hole	Without	
Coating	Without	
Sealing	2RS	Contact seal on both sides

Main Dimensions & Performance Data

F_w	25 mm	Under roller diameter
D	32 mm	Outside diameter
C_r	15.600 N	Basic dynamic load rating, radial
C_{0r}	24.000 N	Basic static load rating, radial
C_{ur}	3.200 N	Fatigue load limit, radial
n_G	6.100 1/min	Limiting speed
n_G Grease	6.100 1/min	Limiting speed for grease lubrication
$\approx m$	30,78 g	Weight

Dimensions

C_1	20 mm	Width, outer ring
r_{min}	0,8 mm	Minimum chamfer dimension

Temperature range



T_{min}	-20 °C	Operating temperature min.
T_{max}	100 °C	Operating temperature max.



Additional information

LR20X25X20,5	Suitable inner rings LR
IR20X25X20-XL	Suitable inner rings IR

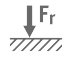
Characteristics

-  Radial load
-  Grease Lubrication
-  Sealed on both sides
-  Small design envelope