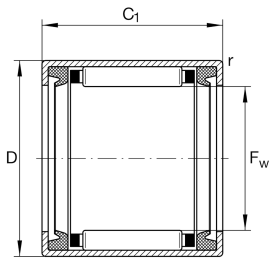

**HK2516-2RS**

Drawn cup needle roller bearing open end

Drawn cup needle roller bearings with open ends HK...-2RS, lip seals on both sides, to DIN 618

Technical information

**Your current product variant**

| | | |
|------------------|---------|---------------------------------|
| Lubricant | L271 | Grease (L271/standart specific) |
| Lubrication hole | Without | |
| Coating | Without | |
| Sealing | 2RS | Contact seal on both sides |

Main Dimensions & Performance Data

| | | |
|-----------------|-------------|---------------------------------------|
| F_w | 25 mm | Under roller diameter |
| D | 32 mm | Outside diameter |
| C_r | 11.000 N | Basic dynamic load rating, radial |
| C_{0r} | 15.200 N | Basic static load rating, radial |
| C_{ur} | 2.030 N | Fatigue load limit, radial |
| n_G | 6.100 1/min | Limiting speed |
| n_G Grease | 6.100 1/min | Limiting speed for grease lubrication |
| $\approx m$ | 23,375 g | Weight |

Dimensions

| | | |
|-----------|--------|---------------------------|
| C_1 | 16 mm | Width, outer ring |
| r_{min} | 0,8 mm | Minimum chamfer dimension |

Temperature range

| | | |
|-----------|--------|----------------------------|
| T_{min} | -20 °C | Operating temperature min. |
| T_{max} | 100 °C | Operating temperature max. |



Additional information

| | |
|---------------|-------------------------|
| LR20X25X16,5 | Suitable inner rings LR |
| IR20X25X17-XL | Suitable inner rings IR |

Characteristics

-  Radial load
-  Grease Lubrication
-  Sealed on both sides
-  Small design envelope