



FAG

QJ210-XL-MPA-C3

Four-point contact bearing

Four point contact bearing QJ2..-XL-MPA, X-life, solid brass cage

X-life

Technical information

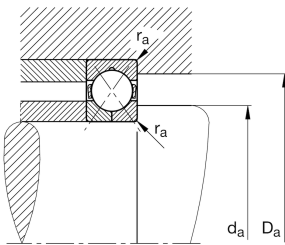
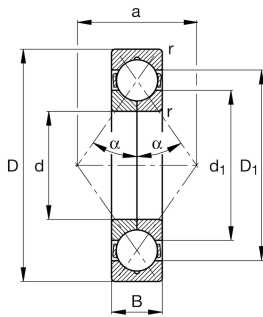

Ваш текущий вариант продукта

Tolerance class	PN	Normal (ISO 492:2023)
Cage	MPA	Solid brass cage, outer ring guided
Dimensional / heat stabilization	S0	Rings dimensional stabilized up to 150°
Axial internal clearance	C3	Group 3 (C3), bigger than CN

Main Dimensions & Performance Data

d	50 mm	Bore diameter
D	90 mm	Outside diameter
B	20 mm	Width
C_r	62.000 N	Basic dynamic load rating, radial
C_{0r}	56.000 N	Basic static load rating, radial
C_{ur}	3.950 N	Fatigue load limit, radial
n_G	15.200 1/min	Limiting speed
n_{gr}	6.700 1/min	Reference speed
m	0,57 kg	Bec

Mounting dimensions

$d_{a \min}$	57 mm	Minimum diameter shaft shoulder
$D_{a \max}$	83 mm	Maximum diameter of housing shoulder
$r_{a \max}$	1 mm	Maximum fillet radius



Dimensions

r_{\min}	1,1 mm	Minimum chamfer dimension
D_1	76,35 mm	Shoulder diameter outer ring
d_1	63,65 mm	Shoulder diameter inner ring
a	49 mm	Distance between the apexes of the pressure cones
α	35 °	Contact angle

Temperature range

T_{\min}	-30 °C	Operating temperature min.
T_{\max}	150 °C	Operating temperature max.

Характеристики

-  Радиальная нагрузка
-  Осевая нагрузка в одном направлении
-  Осевая нагрузка в обоих направлениях
-  Смазывание пластичной смазкой
-  Смазывание маслом
-  Без уплотнений