

**FAG****B71905-C-2RSD-T-P4S-UL**

## Spindle bearing

Spindle bearing B719...-C-2RSD, adjusted, in pairs or sets, contact angle  $\alpha = 15^\circ$ , lip seals on both sides, non-contact, restricted tolerances

## Technical information

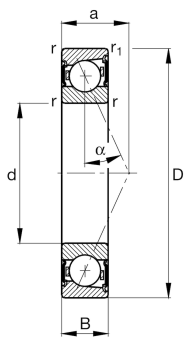

## Your current product variant

Preload	L	Preload light
Contact angle	C	Contact angle $15^\circ$
Tolerance class	P4S	Tolerance class P4S, FAG standard better than P4 to ISO 492:2023
Cage	T	Laminated fabric cage
Arrangement bearing set	U	Single bearing
Lubricant	GA21	Grease for super precision bearings, standard

## Main Dimensions &amp; Performance Data

d	25 mm	Bore diameter
D	42 mm	Outside diameter
B	9 mm	Width
$C_r$	8.000 N	Basic dynamic load rating, radial
$C_{0r}$	3.800 N	Basic static load rating, radial
$C_{ur}$	400 N	Fatigue load limit, radial
$n_G$ Grease	36.000 1/min	Limiting speed for grease lubrication
$\approx m$	43,06 g	Weight



### Mounting dimensions

$d_a$	29 mm	Diameter shaft shoulder
$d_a$	h12	Diameter shaft shoulder clearance
$D_a$	38,5 mm	Shoulder diameter outer ring
$D_a$	H12	Shoulder diameter outer ring clearance
$r_{a \max}$	0,3 mm	Maximum recess radius
$r_{a1 \max}$	0,15 mm	Maximum recess radius
$a$	9 mm	Distance between the apexes of the pressure cones

### Dimensions

$r_{\min}$	0,3 mm	Minimum chamfer dimension
$r_{1 \min}$	0,3 mm	Minimum chamfer dimension
$\alpha$	15 °	Contact angle

### Temperature range

$T_{\min}$	-30 °C	Operating temperature min.
$T_{\max}$	80 °C	Operating temperature max.

### Additional information

$F_{VL}$	34 N	Preload force light
$F_{VM}$	127 N	Preload force medium
$F_{VH}$	265 N	Preload force heavy
$K_{aEL}$	102 N	Lift-off force light
$K_{aEM}$	418 N	Lift-off force medium
$K_{aEH}$	934 N	Lift-off force heavy
$c_{aL}$	25 N/μm	Axial rigidity light
$c_{aM}$	45 N/μm	Axial rigidity medium
$c_{aH}$	66 N/μm	Axial rigidity heavy



### Characteristics

---



Radial load



Axial load in one direction



Lifetime lubrication, freedom from maintenance



Grease Lubrication



Sealed on both sides